

GTS100 GATE SWITCH

Features

- Designed for use in Residential Elevators
- Field Reversible for RH or LH
- Mounts from either the Top or Back
- Positive Acting Contacts
- Contacts Rated for 24vdc, 2A
- 3 - 3/4" Conduit Knock Outs provided
- Direct replacement for GAL Type "G"
- ETL Listed



Accessories

- Gate Switch Mounting Kit
 - Gate Arm with Roller (bronze or gray) & Matching Hardware
 - Steel Bracket for Mounting Gate Switch & Hardware
 - Gate Switch Mounting Hardware



Dimensions

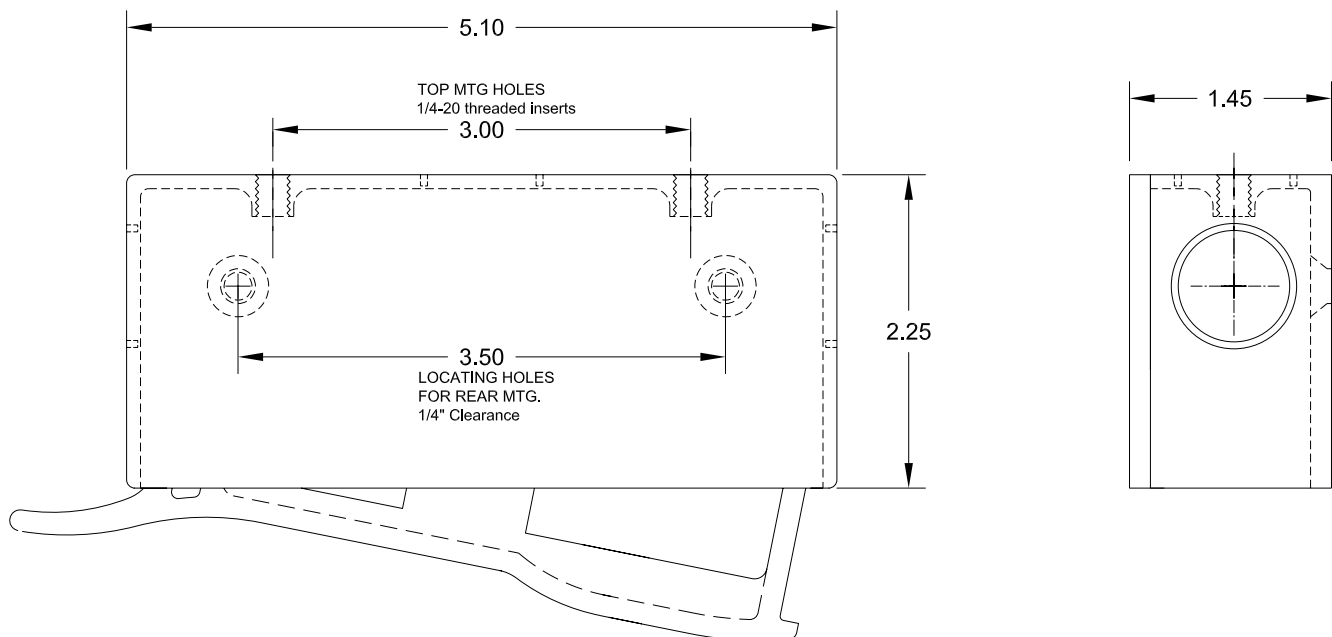

Porta Inc.

250 Hamilton Rd., Arlington Heights, IL 60005
Phone: (847)593-4900 Fax (847) 593-1394

SPEC.: GTS V1
DATE: FEB 2008

MANUFACTURED BY:

